

INDIAN VALLEY

CANYON ROAD SCENIC CORRIDOR

TOWN OF MORAGA, CALIFORNIA

COMPUTER VISUALIZATION EXHIBIT

BEFORE DEVELOPMENT AND AFTER DEVELOPMENT DECEMBER, 2016
 BASED ON EXISTING TOPOGRAPHY AND PROPOSED GRADING DESIGN



PHOTO 1. EXISTING CONDITION LOOKING WEST ALONG CANYON ROAD TOWARD THE COMMUNITY OF CANYON WITH THE PROPERTY ON THE IMMEDIATE RIGHT
 (PHOTO 1 - BEFORE DEVELOPMENT)



PHOTO 2.) EXISTING CONDITION LOOKING NORTH FROM CANYON ROAD INTO THE PROPERTY AT THE LOCATION OF THE PROPOSED ENTRY SHOWN BELOW
 (PHOTO 2 - BEFORE DEVELOPMENT)



COMPUTER VISUALIZATION 1.) VIEW LOOKING WEST ALONG THE CANYON ROAD FRONTAGE OF THE PROPOSED PROJECT ON THE IMMEDIATE RIGHT WHICH IS BEHIND THE KNOLL
 (SIMULATION 1 - AFTER DEVELOPMENT)



COMPUTER VISUALIZATION 2.) VIEW LOOKING NORTH FROM CANYON ROAD TOWARDS THE PROPOSED ENTRY TO THE PROJECT
 (SIMULATION 2 - AFTER DEVELOPMENT)

INDIAN VALLEY

CANYON ROAD SCENIC CORRIDOR

TOWN OF MORAGA, CALIFORNIA

COMPUTER VISUALIZATION EXHIBIT

BEFORE DEVELOPMENT AND AFTER DEVELOPMENT DECEMBER 2016
 BASED ON EXISTING TOPOGRAPHY AND PROPOSED GRADING DESIGN



PHOTO 3. EXISTING CONDITION LOOKING EAST ALONG CANYON ROAD AND THE PROPOSED PROJECT FRONTAGE ON THE IMMEDIATE LEFT SIDE
 (PHOTO 3 - BEFORE DEVELOPMENT)



REFERENCE PHOTO 4. VIEW LOOKING NORTHEAST TOWARDS THE EXISTING CONDITION OF THE PROPERTY FROM AN ELEVATED (22') POSITION ACROSS AND ABOVE CANYON ROAD IN ORDER TO SEE INTO THE VALLEY



COMPUTER VISUALIZATION 3. VIEW LOOKING EAST ALONG THE CANYON ROAD FRONTAGE TOWARDS MORAGA TOWN CENTER OVER THE RIDGE WITH THE PROPOSED PROJECT ON THE IMMEDIATE LEFT
 (SIMULATION 3 - AFTER DEVELOPMENT)

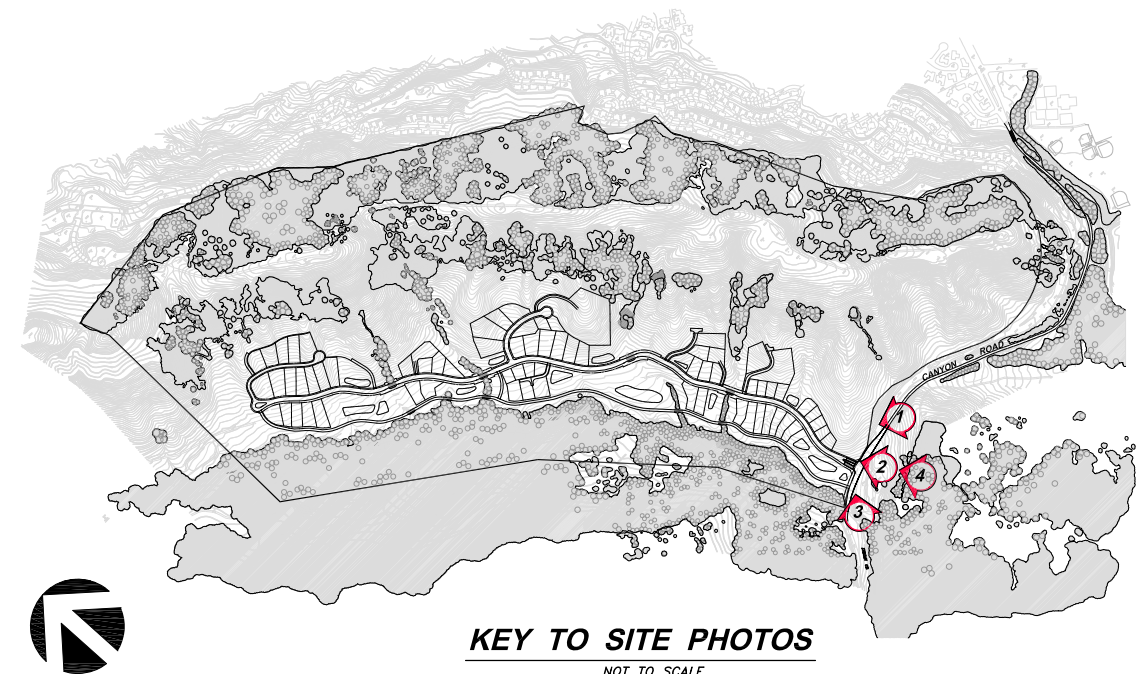

KEY TO SITE PHOTOS
 NOT TO SCALE